



# Series 6 Pressure Switch



## Key Features

- Explosion Proof, Rated for Hazardous Areas
- Field Adjustable
- Low Pressure Switch Available
- All precision machined Anodized aluminum Construction
- 316SS Pressure Ports Available
- All Markings Laser Engraved into body for long lasting durability and visibility
- 11amp UL recognized micro switch standard, gold plated contacts and 5amp micro switch also available
- UL & CSA Approved
- NEMA 4, 4x, 7, 9

## Operating Specifications

<b>Adjustment Range</b>	See Table Below for Options
<b>Circuit Form</b>	SPDT (12), DPDT (33)
<b>Electrical Ratings</b>	11A (RES/IND) - 1/4 HP @125/250VAC 5A RES @ 30VDC 2x 11A (RES/IND) - 1/4 HP @125/250VAC 5A RES @ 30VDC
<b>Pressure Connection</b>	See Ordering Chart Adjacent for Options
<b>Temperature Range</b>	-30°F to 160°F (-34°C to 71°C)
<b>Diaphragm Material</b>	See Ordering Chart Adjacent for Options
<b>Electrical Connection</b>	See Ordering Chart Adjacent for Options

Model	Range ID Number	Switch Adjustment Range		Dead Band Approx.		Max System		Proof Test	
		psi	bar	psi	bar	psi	bar	psi	bar
6A 6Z	.01	2 - 15	0.138 - 1.03	0.2 - 4	0.014 - 0.275	500	34.5	1000	68.9
	.03	5 - 75	0.34 - 5.17	0.5 - 8	0.034 - 0.551	750	51.7	1000	68.9
6C 6G	.43	15 - 200	1.03 - 13.79	2 - 18	0.138 - 1.24	1000	68.9	1250	86.2
	.53	50 - 450	3.45 - 31.03	5 - 33	0.345 - 2.27	1500	103.4	3000	206.8
6C 6G	.62	50 - 1000	3.45 - 68.95	10 - 55	0.69 - 3.79	2000	137.9	5000	344.7
	.63	100 - 1750	6.89 - 120.66	15 - 110	1.03 - 7.58	3000	206.8	5000	344.7
	.64	200 - 2500	13.79 - 172.37	20 - 175	1.38 - 12.06	3000	206.8	5000	344.7
6P	.73	350 - 3250	24.13 - 224.09	50 - 400	3.45 - 27.58	7500	517.1	10000	689.5
6H	.83	400 - 4000	27.58 - 275.29	75 - 500	5.17 - 34.74	5000	344.7	10000	689.5
	.84	500 - 5000	34.47 - 344.74	75 - 500	5.17 - 34.74	7500	517.1	10000	689.5

## Low Pressure Switch

<b>Part Number</b>	6G12N1.12	6G12N1.14
<b>Adj. Range</b>	0.36 - 3.61 psi (10" - 100" WC)	2 - 16 psi (55" - 443" WC)
<b>Deadband</b>	0.027 - 0.144 psi (0.75" - 4" WC)	0.072 - 0.25 psi (2" - 7" WC)
<b>Proof Test</b>	250 psi	250 psi

## How to Order

(Example: Part Number 6G12F1.03)

**6 G 12 F1 .03**

### Range

- 01 2 - 15 psi
- 03 5 - 75 psi
- 43 15 - 200 psi
- 53 50 - 450 psi
- 62 50 - 1000 psi
- 63 100 - 1750 psi
- 64 200 - 2500 psi
- 73\* 350 - 3250 psi
- 83\*\* 400 - 4000 psi
- 84\*\* 500 - 5000 psi

### Diaphragm

- N1 Nitrile Polyamide
- F1 Viton Polyamide
- F2 Viton Stainless Steel
- F6\*\* Viton Polyamide
- N9\* Nitrile SST Piston Teflon

### Electrical Connection

- 12 SPDT (Silver)
- 33 DPDT (Silver)

### Pressure Connection

- A AL 1/2"-14 NPT
- C 316SS 1/4"-18 NPT
- D AL 1/4"-18 NPT
- G AL 1/4"-18 NPT
- H\*\* 316SS 1/4"-18 NPT
- P\* AL 1/4"-18 NPT
- Z 316SS 1/2"-14 NPT

\* Available only for model 6P (Piston Pressure Switch)  
\*\* Available only for model 6H (High Pressure Switch)

• Certified CSA: Cert. file No. LR76122-1 Class I, Div 1 Groups B, C, D; Class II, Div 1 Groups E, F, G, Class 3238 01 -Switches- Automatic Pressure Type for Hazardous Locations.

• Listed by: Underwriters Laboratories Inc. (File No. E123884) Suitable for Class 1, Groups A, B, C, D; Class II, Groups E, F, G.

## Wiring Diagram

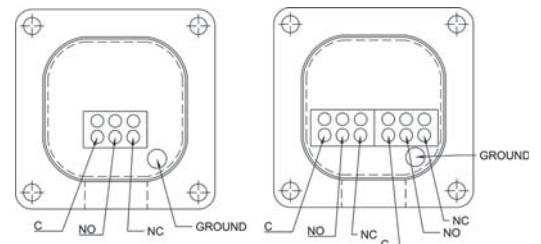



# Series 6 Pressure Switch

## Dimensional Specifications

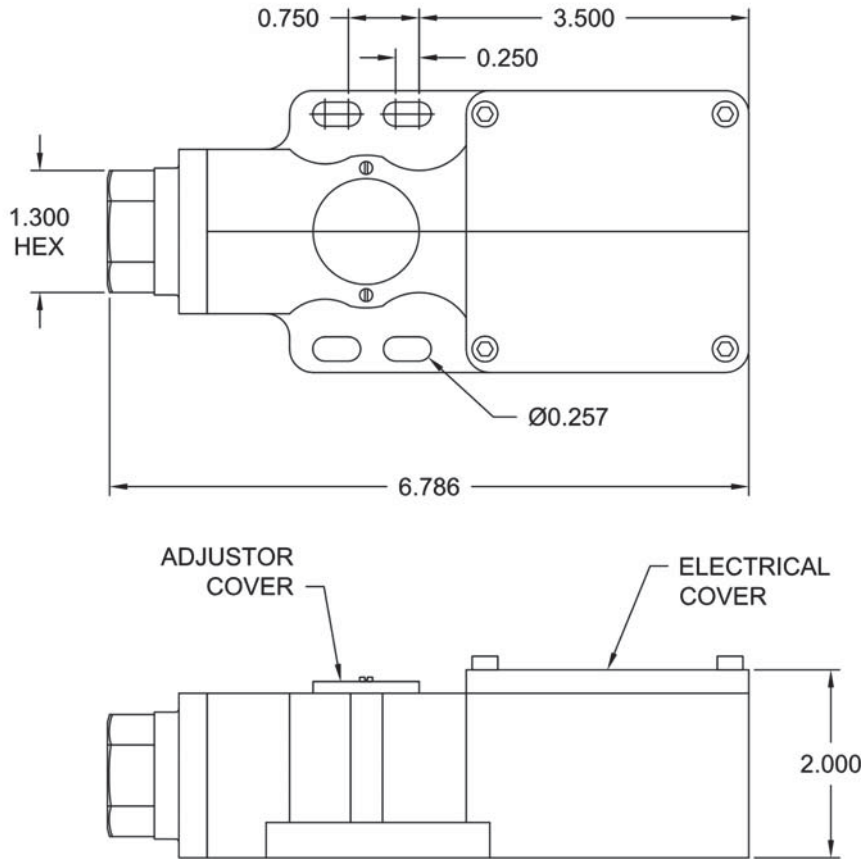

## How to Order

(Example: Part Number 6G12F1.03)

**6 G 12 F1 .03**

**Range**

- 01 2 - 15 psi
- 03 5 - 75 psi
- 43 15 - 200 psi
- 53 50 - 450 psi
- 62 50 - 1000 psi
- 63 100 - 1750 psi
- 64 200 - 2500 psi
- 73\* 350 - 3250 psi
- 83\*\* 400 - 4000 psi
- 84\*\* 500 - 5000 psi

**Diaphragm**

- N1 Nitrile Polyamide
- F1 Viton Polyamide
- F2 Viton Stainless Steel
- F6\*\* Viton Polyamide
- N9\* Nitrile SST Piston Teflon

**Electrical Connection**

- 12 SPDT (Silver)
- 33 DPDT (Silver)

**Pressure Connection**

- A AL 1/2"-14 NPT
- C 316SS 1/4"-18 NPT
- D AL 1/4"-18 NPT
- G AL 1/4"-18 NPT
- H\*\* 316SS 1/4"-18 NPT
- P\* AL 1/4"-18 NPT
- Z 316SS1/2"-14 NPT

\* Available only for model 6P (Piston Pressure Switch)

\*\* Available only for model 6H (High Pressure Switch)